

The Arlington TYPE F

KITCHEN DESIGN

Plot 4 £265,000
 Plot 5-7 £255,000
 Plot 8-10 £265,000
 Plot 11 £269,500

KITCHEN AND UTILITY

Our nominated supplier Rossendale Interiors of Brogden Street, Ulverston (contact Manager, Alan Hunter, Tel: 581828), have designed the attached fully integrated kitchen, utility and appliance package which represents our standard kitchen offer:

- Belling B160MF multifunction single oven
- Belling build-in combination microwave
- Belling 70cm touch control hob
- Caple FGC720 70cm wall chimney hood
- 70cm Black glass splashback
- Belling BSTAT5050 50/50 fridge / freezer
- Belling IDW604 dishwasher
- Caple WD2206 condenser washer dryer
- Astracast lagos compsite 1.5 bowl sink
- Abode Pico Monobloc tap

We offer our customer a choice of worktops and kitchen units including the choice of any of the vast range of Rossendale Interior doors upto Group 9 and any 40 mm laminated worktop and the integrated appliances above scheduled from our nominated supplier Rossendale kitchens.

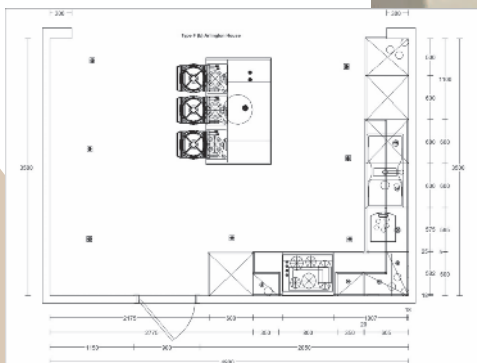
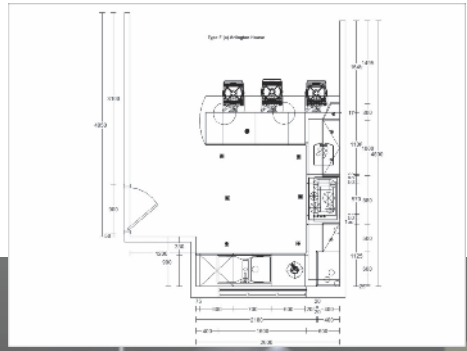

The Arlington TYPE F

BATHROOM DESIGN

Plot 4	£265,000
Plot 5-7	£255,000
Plot 8-10	£265,000
Plot 11	£269,500

BATHROOMS, EN SUITE AND CLOAKROOMS

- We have designed our bathrooms and En Suite shower rooms using the new S50 Designer Range from 'Vitra' with thermostatic shower, wastes and taps and Kudos shower screens.
- This Designer Range from one of the world's leading suppliers of sanitaryware represents timeless functionality and advanced innovation.
- En Suite, main bathrooms and En Suite shower rooms are illustrated in the information pack and can be viewed at BSU Limited, North Lonsdale Road, Ulverston.

MAIN BATHROOM



ENSUITE

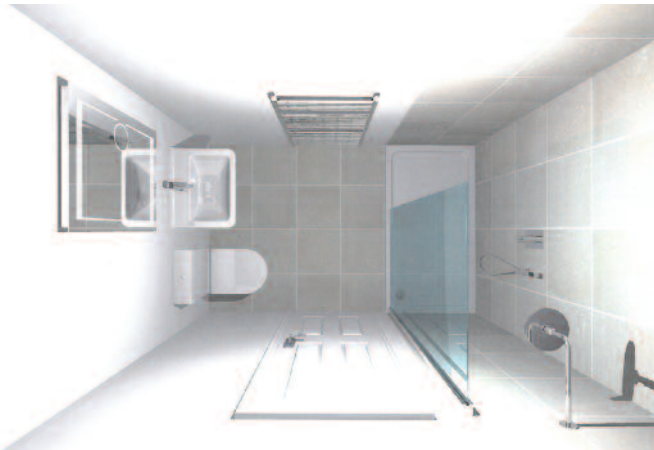

DOWNSTAIRS

